



Introducing one-touch wireless visibility & management

Wireless network discovery, setup, monitoring and management can now be done from the palm of your hand – anytime, anywhere, with NETGEAR Insight app.

Reliable wireless connectivity for employees and customers is a requirement for any business today. All devices are now connected, all users are mobile and “WiFi everywhere” is commonplace. Business owners are often too busy to handle this and need WiFi that just works!

NETGEAR introduces the new IT revolution for small businesses with “One-touch connectivity” with Insight management app. Experience easy set-up, remote management and full control of your wireless network. With 20 years of experience in small & medium business networking, NETGEAR is now delivering wireless connectivity that “just works” at your fingertips.

NETGEAR Insight enables multi-device configuration of your NETGEAR Insight Managed wireless access points, either locally or remotely. It provides network management, monitoring and service deployment across multiple remote and local sites for the easiest and most user-friendly wireless networking experience. Anywhere management also includes Insight Managed switches and Business-Class ReadyNAS on top of Insight Managed Wireless Access points, enabling whole network visibility and management. Insight app also allows you discover select wired and wireless devices from your local or remote network.

Business Features for higher speed, greater coverage and higher density WiFi

- Business class WiFi with superior Wave 2 802.11ac performance and range
- 2x2 with 2 streams of data for aggregate throughput of up to 1.2Gbps (300 Mbps at 2.4GHz and 867 Mbps at 5GHz)
- Multi-User Multiple In Multiple Out (MU-MIMO) avoids congestion and ensures performance in high client density deployments like public WiFi hotspots
- One Ethernet port, with Power-over-Ethernet (PoE) for ease of deployment (PoE switch & AC/DC power adapter are sold separately)
- One-touch network visibility. Anywhere. – Smart Cloud remote app management for unrivaled mobile management experience of your wireless network
- App managed, through NETGEAR Insight app for one-touch installation and management of all your WAC505 and WAC510 Access Points, no additional hardware needed
- Market leading 5-year warranty with 24x7 chat support for peace of mind

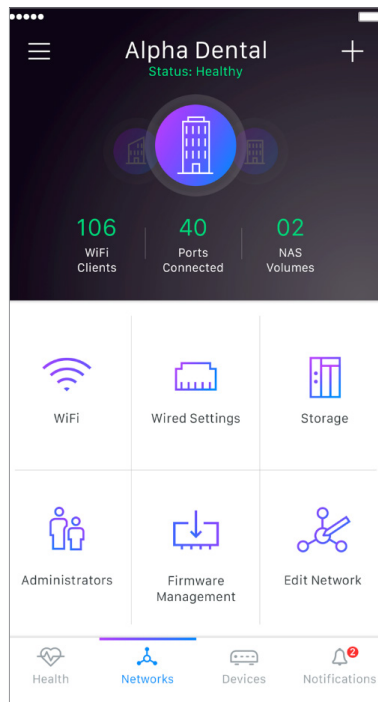

Wired/Wireless Dashboard

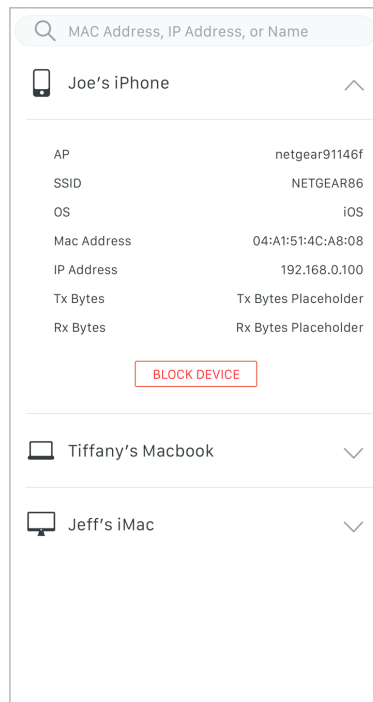

Detailed Client Statistics

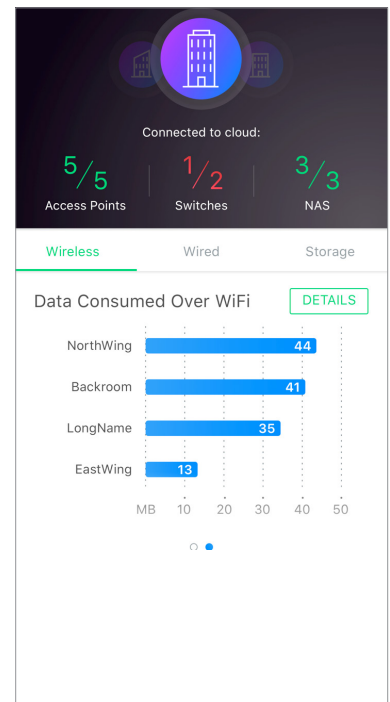

Wired and Wireless Data

Deployment Scenario

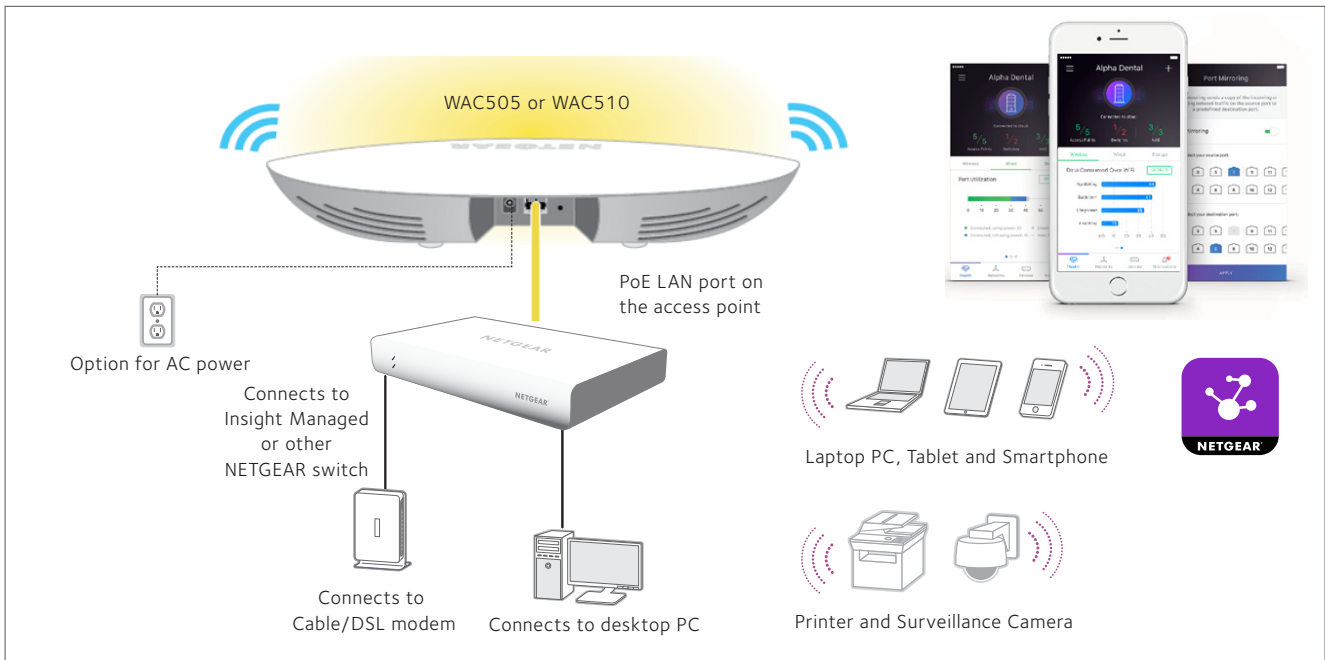

Product Comparison

Features	WAC505	WAC510	WAC720	WAC730	WAC740
Frequency	2.4GHz and 5GHz	2.4GHz and 5GHz	2.4GHz and 5GHz	2.4GHz and 5GHz	2.4GHz and 5GHz
Wireless Mode (Transmit x Receive)	802.11ac (2x2)	802.11ac (2x2)	802.11ac (2x2)	802.11ac (3x3)	802.11ac (4x4)
802.11ac Wave	Wave 2	Wave 2	Wave 1	Wave 1	Wave 2
Multi-User MIMO	Yes	Yes	No	No	Yes
Maximum Theoretical Throughput	1.2Gbps	1.2Gbps	1.2Gbps	1.7Gbps	1.7Gbps
Maximum Throughput (2.4/5GHz)	300/867Mbps (2.4/5GHz)	300/867Mbps (2.4/5GHz)	300/867Mbps (2.4/5GHz)	450/1300Mbps (2.4/5GHz)	600/1700Mbps (2.4/5GHz)
Power over Ethernet (PoE) IEEE 802.3af	Yes	Yes	Yes	Yes	Yes, PoE+
PoE Power Consumption	8.9 Watts	9.3 Watts	11.0 Watts	12.9 Watts	17.9 Watts
Centralized Management	Insight App, Standalone	Insight App, Standalone	Quad Mode Management (Standalone, Ensemble™, Controller, and Business Central)	Quad Mode Management (Standalone, Ensemble™, Controller, and Business Central)	Controller, and Business Central
SNMP	v1, v2c	v1, v2c	v1, v2c	v1, v2c	v1, v2c
Secure SSH	Yes	Yes	Yes	Yes	Yes
Secure Socket Layer (SSL)	Yes	Yes	Yes	Yes	Yes
Router Mode	No	Yes	No	No	No
Wireless Distribution System (WDS)					
Repeater	Yes	Yes	Yes	Yes	No
Bridge point-to-point/multi-point	Yes	Yes	Yes	Yes	No
Simultaneous bridge & wireless client association	Yes	Yes	Yes	Yes	No
Separate bridge and access point	Yes	Yes	Yes	Yes	No
Antenna	Internal 3/4dBi (2.4/5GHz)	Internal 3/5dBi (2.4/5GHz)	Internal 5/6dBi (2.4/5GHz) Three (3) External reverse SMA connectors for 2.4/5GHz antennas	Internal 5/6dBi (2.4/5GHz) Two (2) External reverse SMA connectors for 2.4/5GHz antennas	Internal 5/6dBi (2.4/5GHz) four (4) External reverse SMA connectors for 2.4/5GHz antennas
Security					
WiFi Protected Access (WPA/WPA2), 802.11i	Yes	Yes	Yes	Yes	Yes
MAC address filtering with access control	Yes	Yes	Yes	Yes	Yes
802.1x RADIUS support with EAP TLS, TTLS, PEAP	No	No	Yes	Yes	Yes
Rogue AP detection	Yes	Yes	Yes	Yes	Yes
Block SSID Broadcast	Yes	Yes	Yes	Yes	Yes
VLAN Support	Yes	Yes	Yes	Yes	Yes
Guest Network/Captive Portal	Yes	Yes	Yes	Yes	Yes
Accepts external antennas	No	No	Yes	Yes	Yes
Easy ceiling mounting/wall mouting	Yes	Yes	Yes	Yes	Yes
Bandwidth management	Yes	Yes	Yes	Yes	Yes
Bonjour Gateway	No	No	Yes	Yes	Yes
Link Layer Discovery Protocol	No	No	Yes	Yes	Yes
Bandsteering	Yes	Yes	Yes	Yes	Yes

WAC505 Technical Specifications

Standards

- IEEE 802.11ac Wave 2 standard
- WMM Wireless Multimedia Prioritization
- WDS Wireless Distribution System
- Power over Ethernet (PoE) IEEE 802.3af
- Power over Ethernet (PoE) IEEE 802.3at

Physical Specifications

- Physical Dimensions (W x D x H):
175 x 165 x 35 mm
(6.89 x 6.49 x 1.38 in)
- Weight: 256 g (0.56 lb)

Physical Interfaces

- One 10/100/1000BASE-T Gigabit Ethernet (RJ-45) ports with Auto Uplink™ (Auto MDI-X) supporting IEEE 802.3af or 802.3at Power over Ethernet (PoE)
- Power adapter (not included): 12V DC, 2.5A; plug is localized to country of sale
- Five (5) LED: Power, Link/ACT, LAN, 2.4GHz, 5GHz

Security

- WiFi Protected Access® (WPA, WPA2)
- WPA Enterprise (802.1x)
- Wireless access control to identify authorized wireless network devices
- MAC address authentication

Network Management

- NETGEAR Insight App Management for setup, monitoring and management
- SNMP v1, v2

Advanced Wireless

Wireless Distribution System (WDS)

- Bridge mode: Point-to-point wireless
- Bridge mode: Point-to-multipoint wireless
- Repeater mode
- Adjustable Transmit Power Control (TPC)

Device detection

- Identify type of wireless clients in the network

Package Contents

- (WAC505) Insight Managed Smart Cloud Wireless Access Point
- Wall/ceiling mount kit
- Installation guide

NETGEAR Warranty*

- NETGEAR 5-year hardware warranty

Ordering Information

- **WAC505-10000S**
Everywhere except US and Canada
- **WAC505-100NAS**
US and Canada
- **WAC505PA-100NAS**
WAC505 with power adapter for US and Canada
- **WAC505B03-10000S**
3 pack of WAC505 for everywhere except US and Canada
- **WAC505B03-100NAS**
3 pack of WAC505 for US and Canada
- **WAC505B05-10000S**
5 pack of WAC505 for everywhere except US and Canada
- **WAC505B05-100NAS**
5 pack of WAC505 for US and Canada

Power Adapters

- **PAV12V-100NAS**
US and Canada
- **PAV12V-100UKS**
UK
- **PAV12V-100EUS**
Europe except UK
- **PAV12V-100PRS**
China
- **PAV12V-100AUS**
Australia and New Zealand

WAC510 Technical Specifications

Standards

- IEEE 802.11ac Wave 2 standard
- WMM Wireless Multimedia Prioritization
- WDS Wireless Distribution System
- Power over Ethernet (PoE) IEEE 802.3af
- Power over Ethernet (PoE) IEEE 802.3at

Physical Specifications

- Physical Dimensions (W x D x H):
197.32 x 197.32 x 37mm
(7.75 x 7.75 x 1.45in)
- Weight: 555.5g (1.22lb)

Physical Interfaces

- Two (WAN/LAN) 10/100/1000BASE-T Gigabit Ethernet (RJ-45) ports with Auto Uplink™ (Auto MDI-X) with WAN port supporting IEEE 802.3af or 802.3at Power over Ethernet (PoE)
- Power adapter (not included): 12V DC, 2.5A; plug is localized to country of sale
- Six (6) LED: Power, Link/ACT, LAN1, LAN2, 2.4GHz, 5GHz

Security

- WiFi Protected Access® (WPA, WPA2)
- Wireless access control to identify authorized wireless network devices
- MAC address authentication

Network Management

- NETGEAR Insight App Management for setup, monitoring and management
- SNMP v1, v2

Advanced Wireless

Wireless Distribution System (WDS)

- Bridge mode: Point-to-point wireless
- Bridge mode: Point-to-multipoint wireless
- Repeater mode
- Adjustable Transmit Power Control (TPC)

Device detection

- Identify type of wireless clients in the network

Package Contents

- (WAC510) Insight Managed Smart Cloud Wireless Access Point
- Wall/ceiling mount kit
- Installation guide

NETGEAR Warranty*

- NETGEAR 5-year hardware warranty

Ordering Information

- **WAC510-10000S**
Everywhere except US and Canada
- **WAC510-100NAS**
US and Canada
- **WAC510-10000S**
Everywhere except US and Canada
- **WAC510PA-100NAS**
WAC510 with power adapter for US and Canada
- **WAC510B03-10000S**
3 pack of WAC510 for everywhere except US and Canada
- **WAC510B03-100NAS**
3 pack of WAC510 for US and Canada

Power Adapters

- **PAV12V-100NAS**
US and Canada
- **PAV12V-100UKS**
UK
- **PAV12V-100EUS**
Europe except UK
- **PAV12V-100PRS**
China
- **PAV12V-100AUS**
Australia and New Zealand

* This product comes with a 5-year hardware limited warranty that is valid only if purchased from a NETGEAR authorized reseller, and modifications to product may void the warranty—not software or external power supplies; see <http://www.netgear.com/about/warranty/> for details. Technical support includes basic phone support for 90 days from purchase date and lifetime online chat support when purchased from a NETGEAR authorized reseller. This product was tested for quality and its components may be recycled. For indoor use only.